

Electric Vacuum Unit EVA-01 (EVA200-*-* Instruction Manual

Please read this instruction manual carefully
before operating this unit and use our product correctly.
After reading this instruction manual, be sure to keep it in a place where a person
who uses or manages the equipment can check it at any time.



※Dresser sold separately

Table of Contents





1.	Safety Precautions	2
2.	Spec, Dimensions	3
3.	Parts List	4
4.	Assembly procedure	6
5.	Wiring	10
6.	Cautions and Confirmation before the Operation	11
7.	Disposal of chips	12
8.	Timing Chart	13
9.	Maintenance	14
10.	Troubleshooting	17
11.	Consumption Parts List	18
	Contact	19

1. Safety Precautions

■Introduction

When used with a dresser manufactured by KYOKUTOH, this chip collector will efficiently collect the chips that are generated during dresser operation. Please do not use for any purpose other than described in this manual. We are not be able to take a responsibility for any damage or injury caused by results other than specified in this manual.

■Regarding Signs

 Warning	It indicates contents informing possibilities of death or serious injury in case of incorrect handling.
 Caution	It indicates contents informing possibilities of injury due to handling error or occurrence of material damages.
	This symbol indicates operations that should not be done.
	This symbol indicates operation that should be done.



■working voltage

Please be sure to check the customer's operating environment before installation.

EVA-01 operates at 200V.

Please do not use the EVA-01 with a power supply other than 200V as it may cause accidents or malfunctions.

■Handling precautions

	No change in pipe diameter or length will be made. ※*If modified from standard parts, performance may not be ensured.
	Always check the power supply on the equipment side. *Designed for use with single-phase 200V
	Wiring must be done by a person with electrical knowledge.

2. Spec、Dimensions

■Spec

Blower Method	Bypass type
Voltage (V)	Single phase AC200V
Watt (W)	1000W
Current (A)	6.1A
Weight (kg)	About 5.35kg
Filter Material	Polyester
Filter Heatproof Temperature	About 180°C

■Dimensions

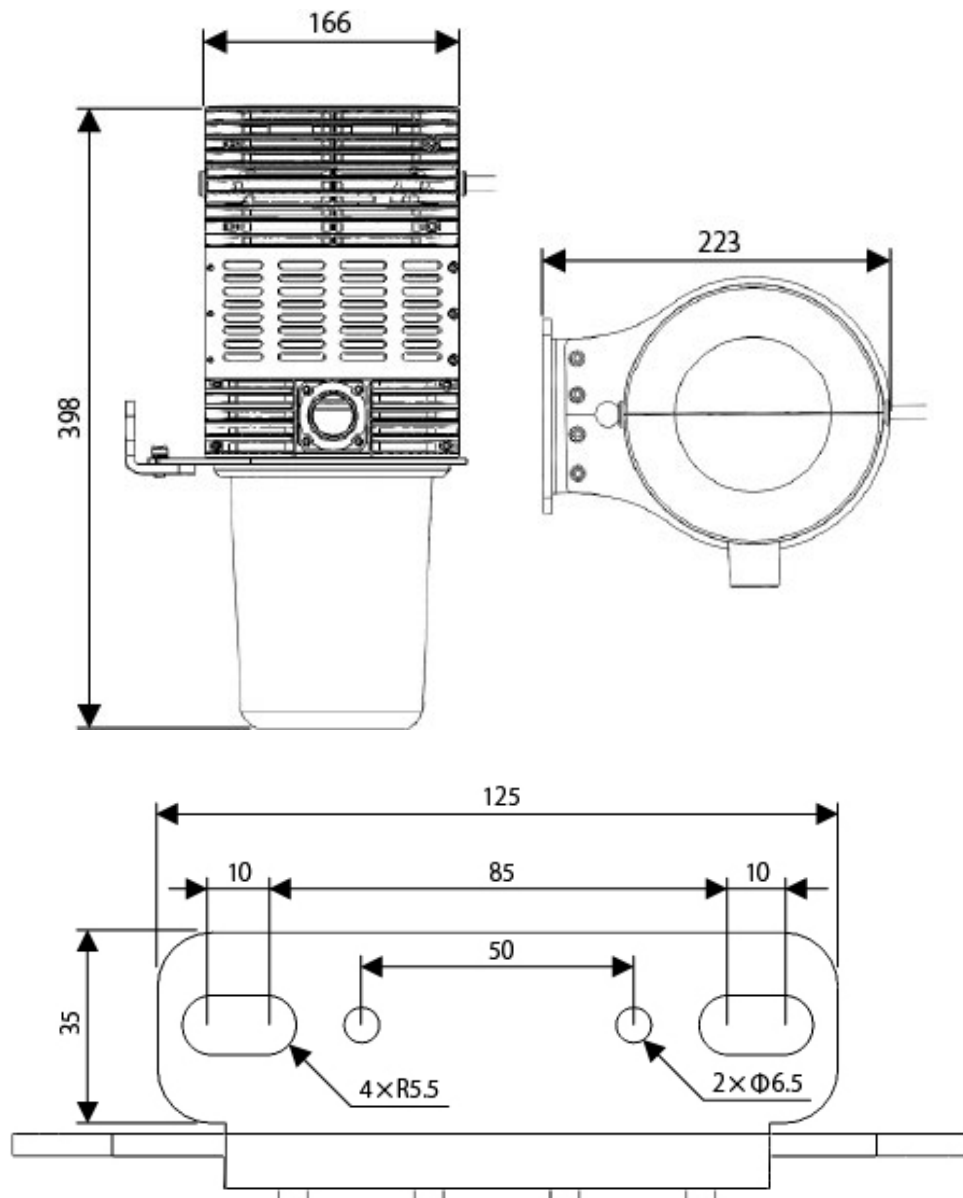

3. Parts List

■Body

No.	Name	Model	QTY
1	Body 1	EVA01-BD1	2
2	Body 2	EVA01-BD2	1
3	Dust Box	EVA01-BD3	1
4	Nozzle 4015	EVA01-NOZ2-4015	1
5	Nozzle 2	EVA01-NOZ2	1
7	Grommet	GMC-1108	1
8	O-ring	CO7345A	1
9	Filter	EVA01-FIL1	1

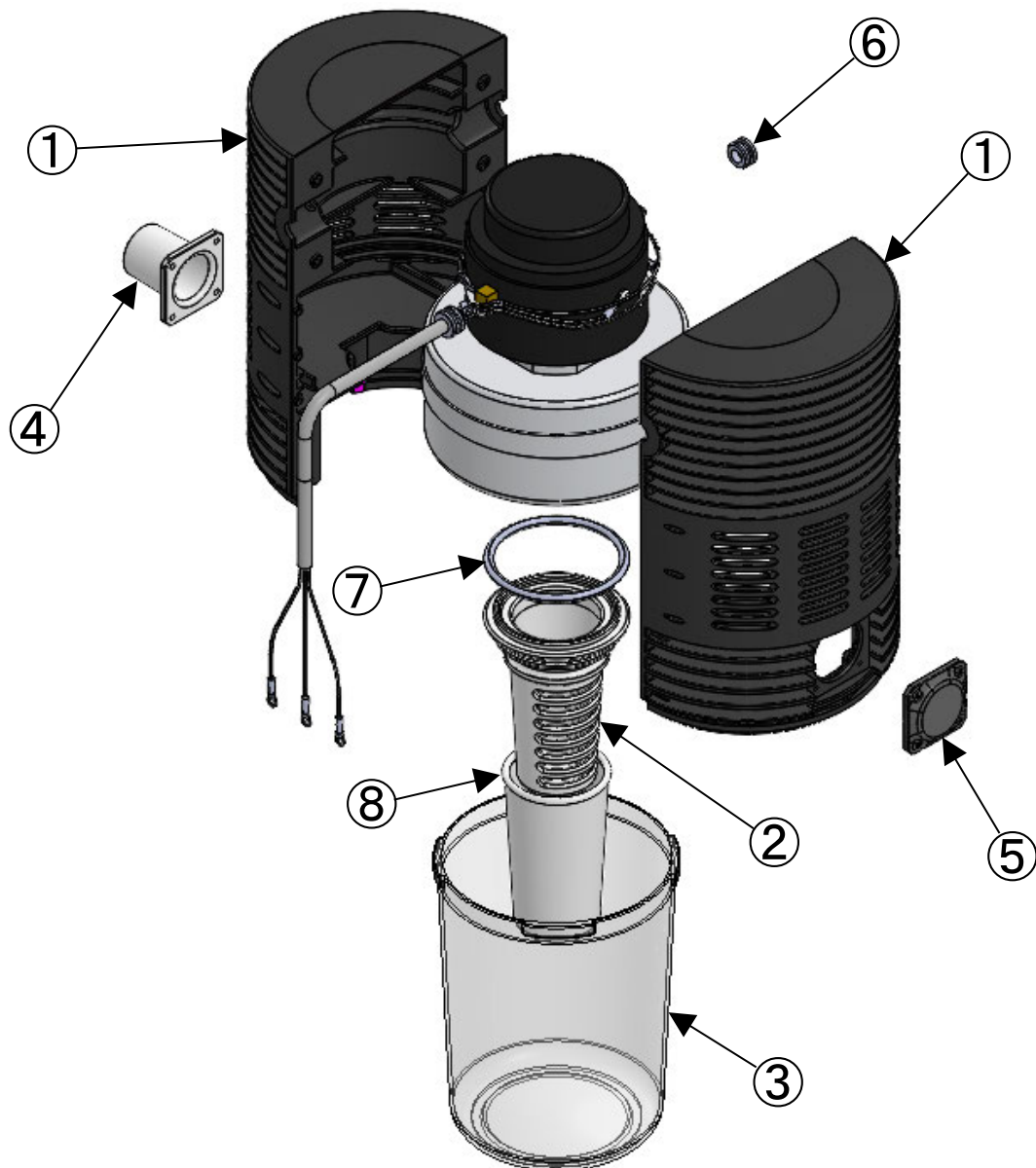

■Corrector and Hose

No.	Name	Model	QTY
1	Chip collector	CVC-BODY-PO-4015-SET	1
2	Adapter	CVC5-K-ADPT-01-001-SET	1
3	Holder cover	TCCR-JF03-H-SET	1
4	One-touch hose band	N2BM3440	2
5	Hose (1m)	NS34	1
6	EVA-01 Bracket	EVA-MT-SET	1

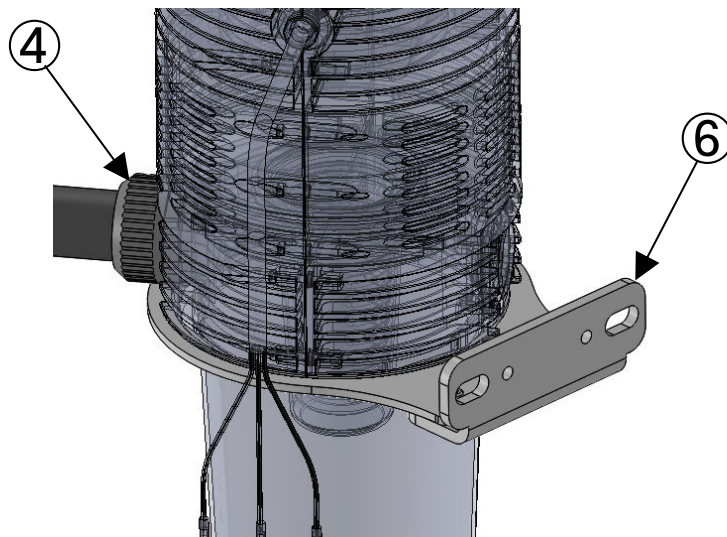
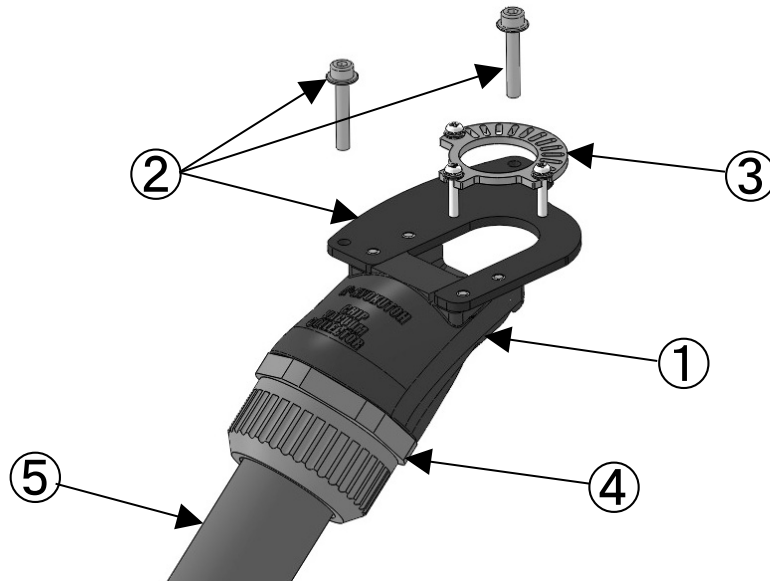

4. Assembly procedure

※For CDK-R

■Procedure

1. Remove the bolt (M5-16L x 2pcs) referring to the figure below.

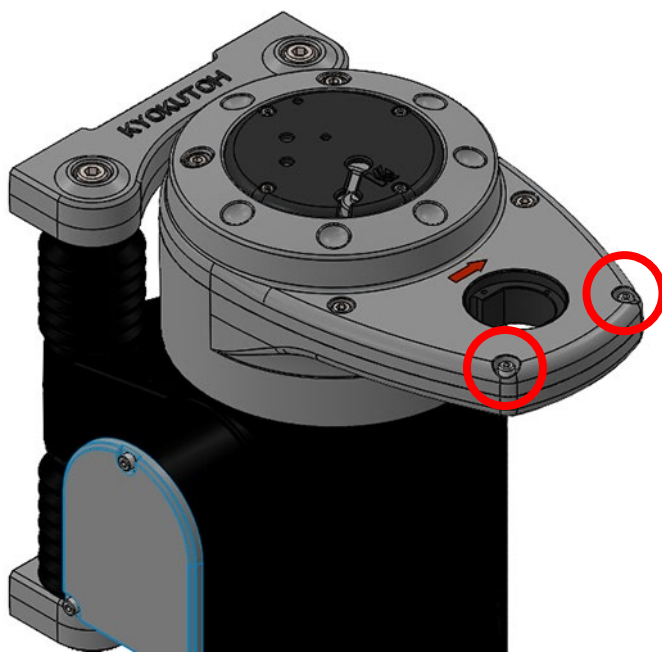

2. Mount an adopter with accessory cap bolts and Washer (M4-30L x 2pcs and M4).

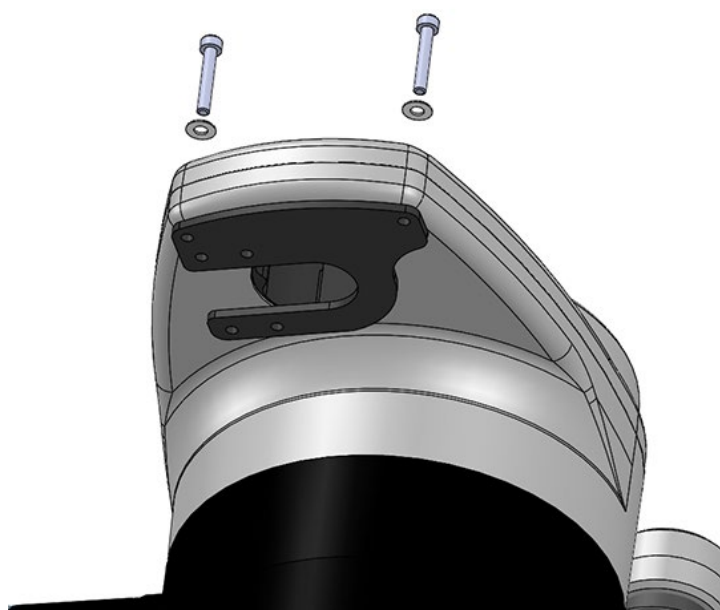

3. Mount a chip collector with 3-point sems bolt (M4-8L x 4pcs) on the adopter.

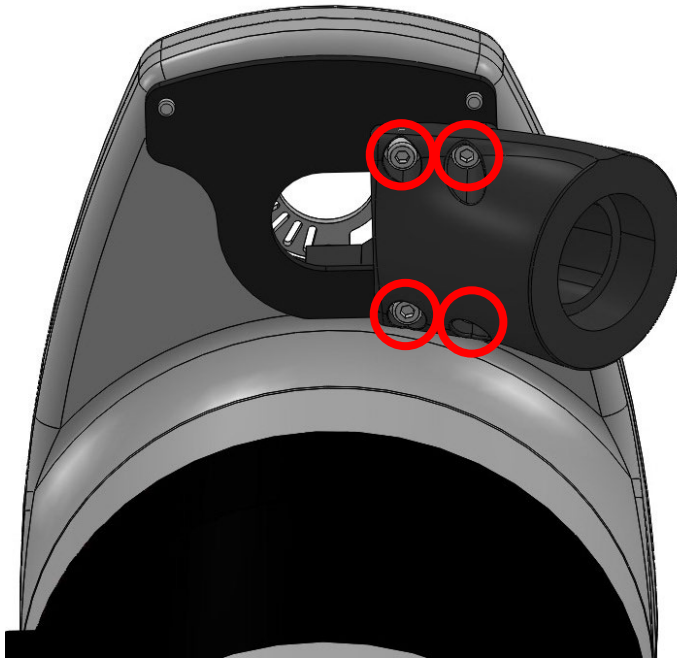

4. Attach hose to chip collector.

※For the hose, a standard 1 (m) hose comes included. Cut it before use if it is too long.

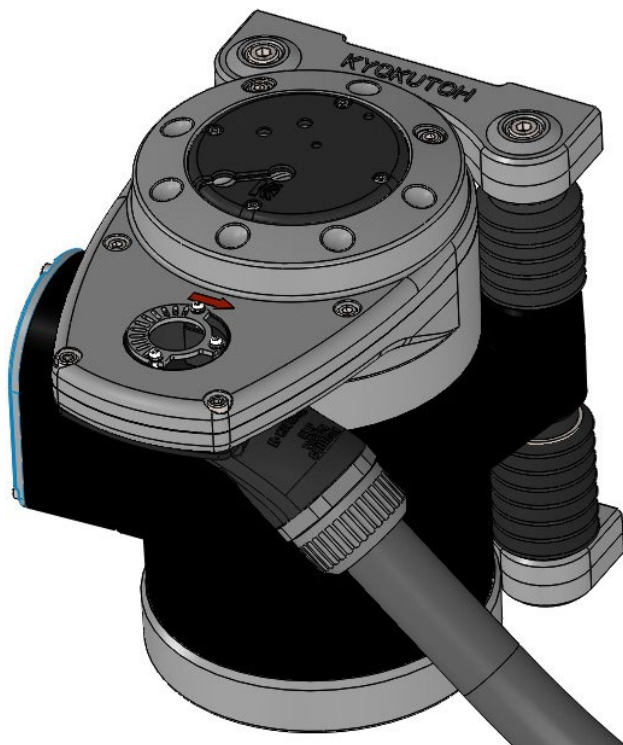

Attach the hose and hose band to the EVA body.

※A 1 m hose is included as standard, but if it is too long, it should be cut off and adjusted.



5. Attach the holder cover.

※For KTWHL holder, two mounting screws. (Image shows KH holder)

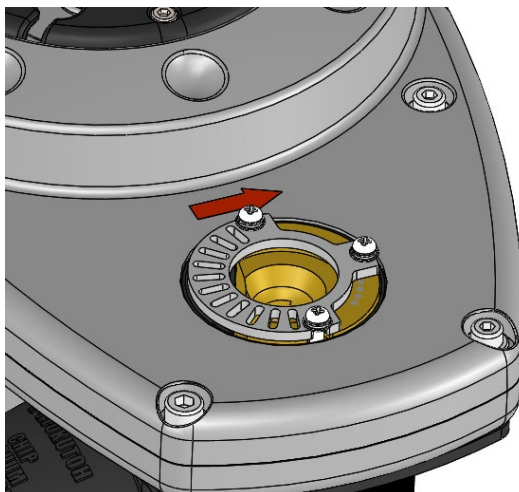

6. Completion.

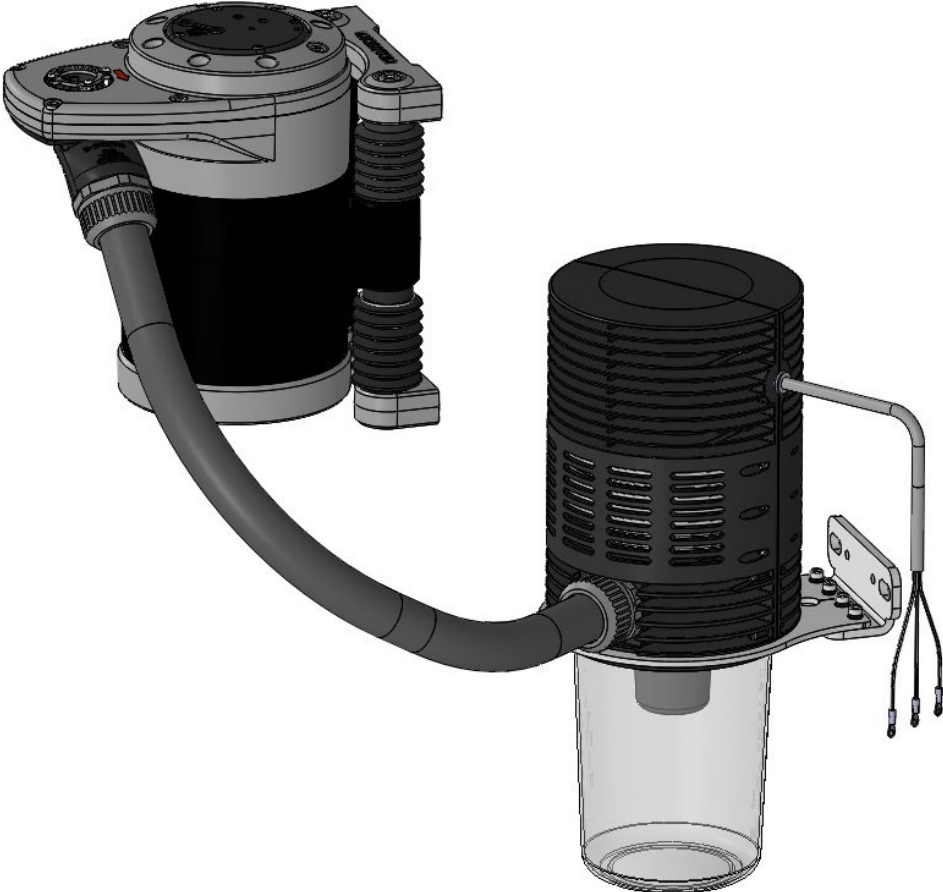

5. Wiring

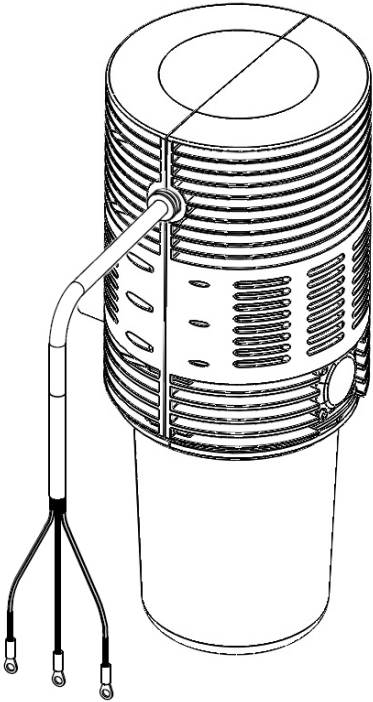

Wiring color "white"
Marker tube notation "FG"

Wiring color "black"
Marker tube notation "W"

Wiring color "red"
Marker tube notation "U"

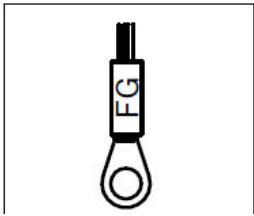
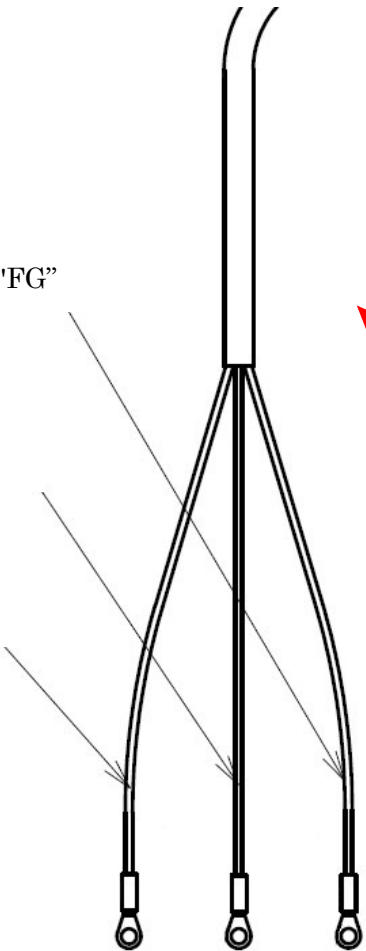

Example of marker tube
(Note the direction of the letters.)

6. Cautions and Confirmation before the Operation

■Notes

1. For the hose, a standard 1-m hose comes included.
Cut it before use if it is too long.
2. If you use the hose with it bent at an acute angle, it may cause chip clogging or hose damage, so please use it with an appropriate bend angle (100R or more).
3. Although the hose is made of flame-retardant material, it cannot withstand extreme heat.
Do not use in environments where ignition is possible.
4. If you use the hose with a length of more than 1m, the product may not be able to demonstrate its proper performance due to lowering the suction force.
5. Tightening the screws with strong force may cause damage.

Check the above notes before starting the operation.

7. Disposal of chips

■Notes

Please discharge dust before chips completely clog the dust box.

Although it varies depending on the product and usage conditions, the dust box will be full after approximately 2,500 dress of a typical $\phi 16$ chip.

Using the product with accumulated chips without disposing of them may cause malfunction of the product.

■Procedure

1. Remove the dust box.

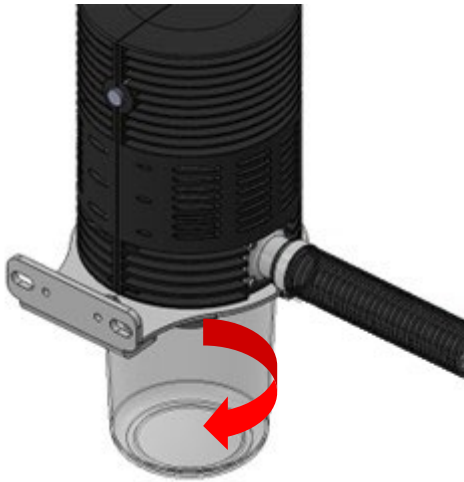

2. Dispose of the chips and assemble the dust box.

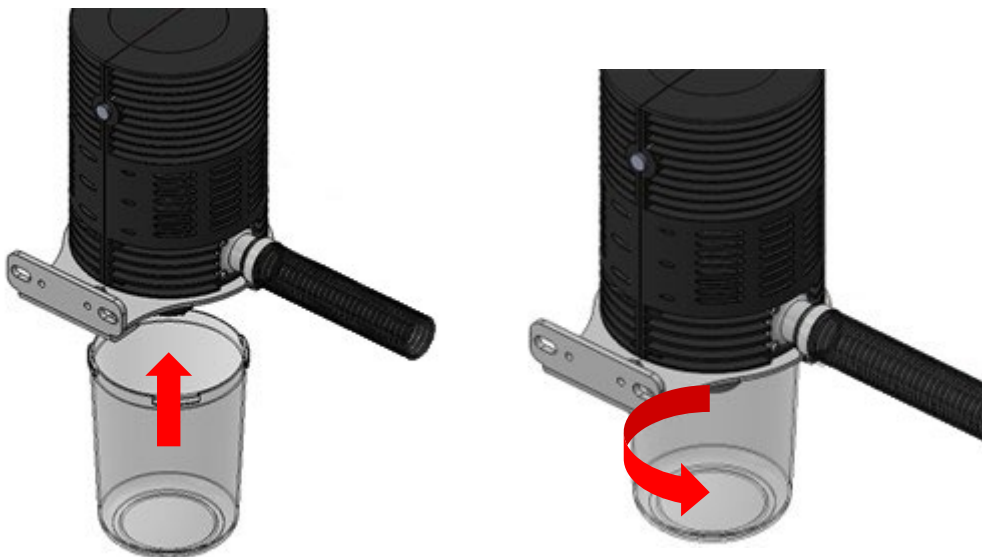

8. Timing Chart

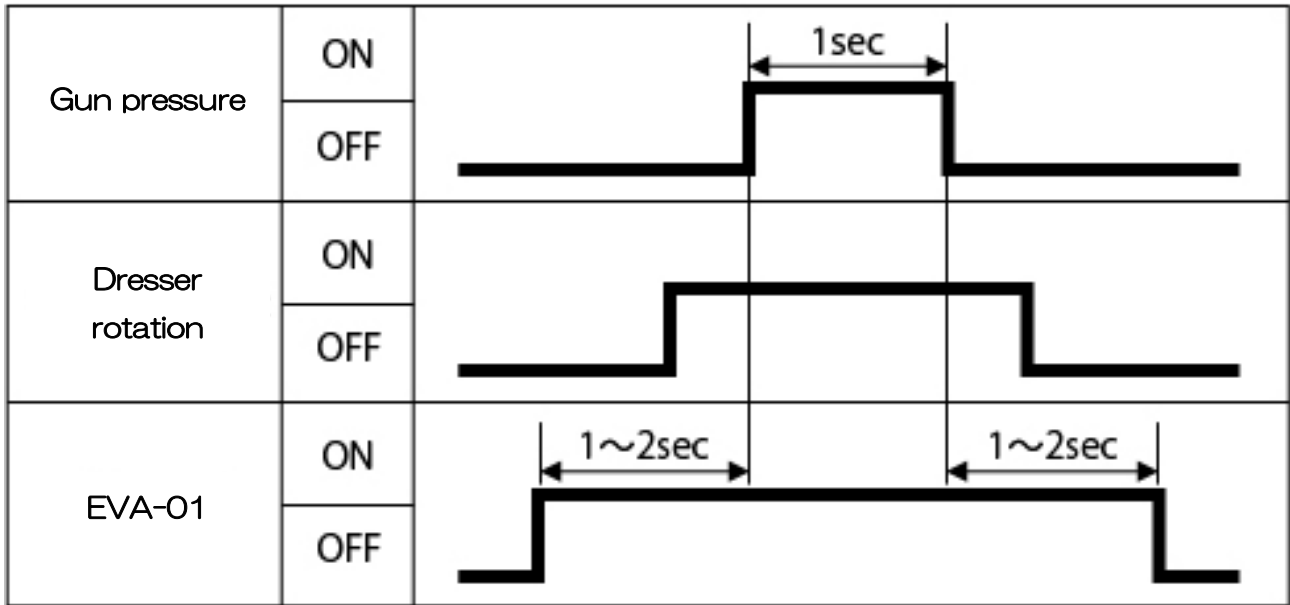

Make adjustments as necessary, referring to the above.

9. Maintenance

■Cleaning

Check chips clogging in CVC and clean it up regularly.

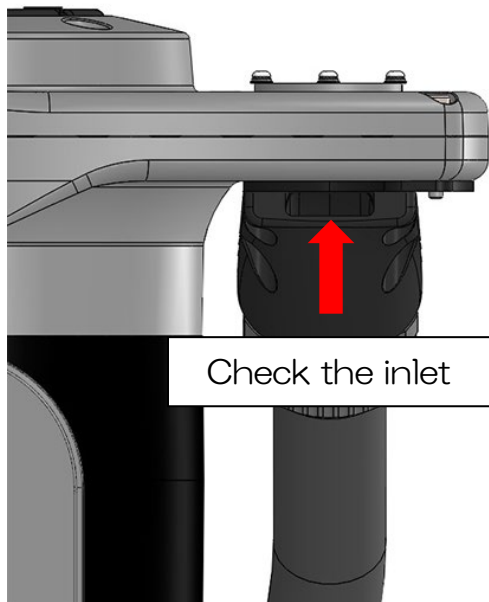

■Inspection

An adapter plate is designed and made thinly to keep wide acceptance for a gun access. Check if the plate has no bent.

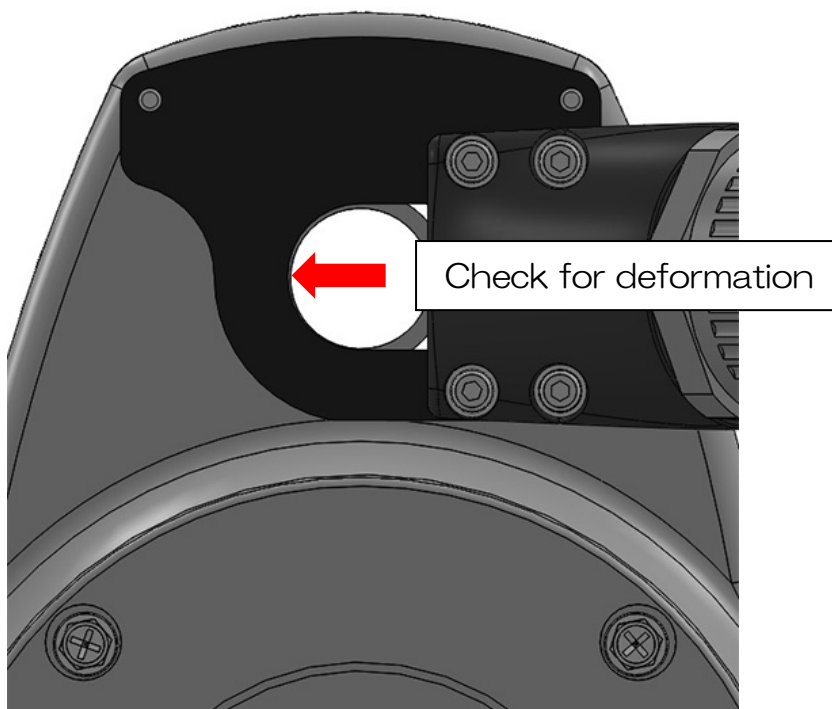

■ Filter replacement

Replace the filter after approximately 5000 uses or when damage such as tears are found.

1. Remove the filter by pulling the underside of the filter.



2. fold over the top of the new filter, aligning it with the seam.



3. put it over the tubular part of the EVA body and replace the part that was just folded back
.✘It is hard, so work with care to avoid tearing.



4. completion



10. Troubleshooting

■If the suction is poor

1. If the discharge hose is extended, it may cause performance degradation.
2. If the hose is bent at an acute angle, the product may not be able to demonstrate its proper performance.
It may also cause a fault, so use the hose with a moderate curvature (R100 or less).
3. Check that chips have not built up in the chip receiving section.

11. Consumption Parts List



Filter

Model : EVA01-FIL1

QTY : 1 pc

Replacement Cycle : 5000times

Contact

Contact us if there is any damage or machine defects in our products.



KYOKUTOH CO., LTD.

181-1, Nakayashiki, Orido-cho, Nisshin, Aichi 470-0115 Japan

TEL +81-561-72-8811 FAX +81-561-72-8821

E-Mail: sales@kyokutoh.com

<http://www.kyokutoh.com>

SAITAMA SALES OFFICE

TEL +81-49-277-4324 FAX +81-49-277-4325

HIROSHIMA SALES OFFICE

TEL +81-82-569-6227 FAX +81-82-569-6228

FUKUOKA SALES OFFICE

TEL +81-92-410-6977 FAX +81-92-410-6988



CHANGER & DRESSER CORPORATION

1527 ITC Way, Anniston, AL 36207 U.S.A

TEL +1-256-832-4392 FAX +1-256-832-4393

<http://www.changer-dresser.com>



KYOKUTOH CHINA

73 Huagang Street, Xiuquan Town, Huadu District,

GuangZhou City, GuangDong Province, China.

TEL +86-20-86980880 FAX +86-20-86980890

<http://www.kyokutoh.com.cn>



KYOKUTOH THAILAND

339/2 Soi Phattanakarn 69, Phattanakarn Road, Prawet,

Bangkok 10250 THAILAND

TEL +66-272-162-82 FAX +66-272-162-84

<http://www.kyokutoh.co.th>



KYOKUTOH KOREA

117, Tawon TAKRA II Industry Center, Dongsan-ro 76,

Danwon-gu, Ansan-si, Gyeonggi-do, Korea 15434

TEL +82-31-414-8730 FAX +82-31-414-8731



KYOKUTOH EUROPE

Max-Planck-Str.4 59423 Unna Germany

TEL +49-2303-93-615-00 FAX +49-2303-93-615-29

<http://www.kyokutoh.de>

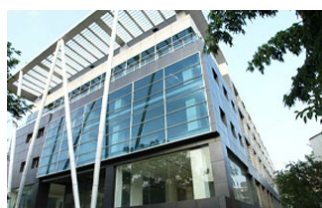

KYOKUTOH WELD INDIA

Office No.19, 3rd Floor, Aditya Centeegra, FC Road, Deccan,

Pune - 411004

TEL +91-20-68297011 FAX +91-20-68297011

